

CONNECT + CONTROL



Pegler Yorkshire



PRESS-FIT SYSTEMS FOR DIVERSE APPLICATIONS

CONNECT WITH CONFIDENCE

XPress





Please visit the PY website for full dimensional data and drawings

S1/7270 Straight coupling

Connection: Press x press

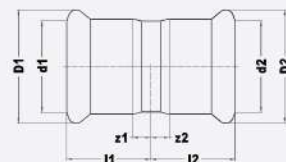

Size	l1	d1	D1	z1	l2	d2	D2	z2	DN1	DN2	Code
12mm	21	12	19	4	21	12	19	4	DN10	DN10	38009
15mm	22	15	23	2	22	15	23	2	DN12	DN12	38010
18mm	22	18	26	2	22	18	26	2	DN15	DN15	38011
22mm	23	22	31	2	23	22	31	2	DN20	DN20	38020
28mm	25	28	37	2	25	28	37	2	DN25	DN25	38030
35mm	28	35	44	2	28	35	44	2	DN32	DN32	38032
42mm	36	42	53	4	36	42	53	4	DN40	DN40	38034
54mm	42	54	65	5	42	54	65	5	DN50	DN50	38035
66.7mm	55	67	83	5	55	67	83	5	DN65	DN65	38036
76.1mm	55	76	94	5	55	76	94	5	DN65	DN65	38037
88.9mm	66	89	108	8	132	89	108	8	DN80	DN80	38039
108mm	72	108	132	5	72	108	132	5	DN100	DN100	38038

S1FMF/7520 Composite female metric flange PN16

Connection: Press x powder coated steel flange to EN1092-1:1997 (BS4504)

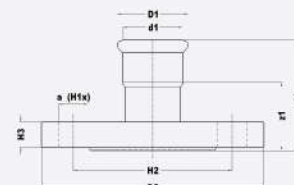

Size	H1	H2	H3	a	l1	d1	D1	z1	D2	DN1	Code
66.7mm DN65 (2 1/2")	4	145	20	18	103	67	83	53	185	DN65	38364
76.1mm DN65 (3")	4	145	20	18	103	76	94	53	-	DN65	38369
76.1mm DN80 (3")	8	160	20	18	103	76	94	53	200	DN80	38365
88.9mm DN80 (3")	8	160	20	18	113	89	108	51	200	DN80	38366
108mm DN100 (4")	8	180	20	18	126	108	132	59	220	DN100	38367

S1FMM/7520 Composite female metric flange PN16

Male end for insertion into fitting x powder coated steel flange to EN1092-1:1997 (BS4504)

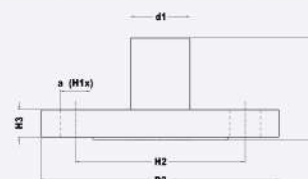

Size	H1	H2	H3	a	l1	d1	DN1	Code
66.7mm DN65 (2 1/2")	4	145	20	18	112	67	DN65	38359
76.1mm DN80 (3")	8	160	20	18	113	76	DN65	38360
108mm DN100 (4")	8	180	20	18	141	108	DN100	38362

FEATURES

✚ Leak Before Press (LBP) technology identifies joints that have not been pressed correctly in sizes 15mm-54mm

✚ Designed for use in hot and cold water services, closed circuit heating, chilled water and oil free compressed air applications

✚ Heat free jointing provides time and cost saving benefits to contractors/installers

S1Slip/7270S Straight coupling slip patterning

Connection: Press x press (without tube stop)

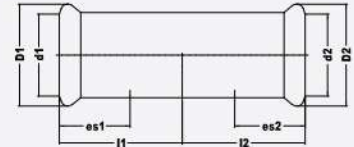

Size	l1	d1	D1	l2	d2	D2	DN1	DN2	Code
15mm	40	15	23	40	15	23	DN12	DN12	38044
18mm	40	18	26	40	18	26	DN15	DN15	38054
22mm	42	22	31	42	22	31	DN20	DN20	38045
28mm	46	28	37	46	28	37	DN25	DN25	38046
35mm	50	35	44	50	35	44	DN32	DN32	38047
42mm	60	42	53	60	42	53	DN40	DN40	38048
54mm	71	54	65	71	54	65	DN50	DN50	38049
66.7mm	55	67	83	55	67	83	DN65	DN65	38040
76.1mm	55	67	83	55	67	83	DN65	DN65	38041
88.9mm	66	76	94	55	76	94	DN65	DN65	38042
108mm	72	108	132	72	108	132	DN100	DN100	38043

S1R/7240 Straight Reducing Coupling

Press x press

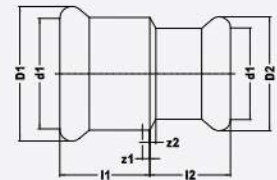

Size	l1	d1	D1	z1	l2	d2	D2	z2	DN1	DN2	Code
15 x 12mm	23	15	23	3	22	12	19	5	DN12	DN10	38063
16 x 15mm	42	16	24	2	-	15	23	-	DN15	DN12	38061
22 x 15mm	28	22	31	7	25	15	23	5	DN20	DN12	38064
28 x 15mm	35	28	37	12	23	15	23	3	DN25	DN12	38065
28 x 22mm	29	28	37	6	26	22	31	5	DN25	DN20	38066
35 x 28mm	33	35	44	7	28	28	37	5	DN32	DN25	38067
42 x 35mm	37	42	53	7	31	35	44	5	DN40	DN32	38068
54 x 42mm	46	54	65	11	34	42	53	4	DN50	DN40	38069



S2/6270G

Straight female connector

Press x BSP parallel female thread

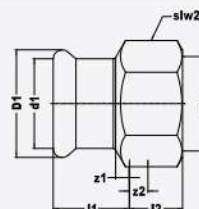

Size	l1	d1	D1	z1	l2	z2	slw2	sks2	DN1	DN2	Code
12mm x Rp3/8"	17	12	19	0	14	6	20	21	DN10	3/8" (DN10)	38082
12mm x Rp1/2"	18	12	19	0	17	8	22	26	DN10	1/2" (DN15)	38081
15mm x Rp3/8"	20	15	23	2	14	6	20	21	DN12	3/4" (DN20)	38083
15mm x Rp1/2"	20	15	23	3	18	8	25	29	DN12	1/2" (DN15)	38090
15mm x Rp3/4"	21	15	23	5	19	8	30	32	DN12	3/8" (DN10)	38091
18mm x Rp1/2"	19	18	26	2	18	8	25	27	DN15	1/2" (DN15)	38084
18mm x Rp3/4"	20	18	26	2	19	9	30	32	DN15	3/4" (DN20)	38085
22mm x Rp1/2"	20	22	31	1	17	7	30	32	DN20	3/4" (DN20)	38086
22mm x Rp3/4"	20	22	31	0	19	9	30	32	DN20	1" (DN25)	38092
22mm x Rp1"	21	22	31	3	22	11	37	39	DN20	1/2" (DN15)	38087
28mm x Rp3/4"	23	28	37	3	17	7	37	39	DN25	1 1/4" (DN32)	38088
28mm x Rp1"	23	28	37	3	22	10	37	39	DN25	3/4" (DN20)	38093
28mm x Rp1 1/4"	24	28	37	2	24	10	46	49	DN25	1" (DN25)	38103
35mm x Rp3/4"	29	35	44	4	15	4	30	32	DN32	1 1/4" (DN32)	38080
35mm x Rp1"	24	35	44	5	22	10	42	44	DN32	3/4" (DN20)	38089
35mm x Rp1 1/4"	25	35	44	3	25	11	46	49	DN32	1" (DN25)	38094
42mm x Rp1 1/4"	30	42	53	0	22	8	46	49	DN40	1 1/2" (DN40)	38101
42mm x Rp1 1/2"	29	42	53	3	25	11	48	56	DN40	1 1/4" (DN32)	38095
54mm x Rp2"	34	54	65	3	25	11	48	56	DN50	1 1/4" (DN32)	38096
64mm x Rp2 1/2"	49	64	80	1	40	9	82	85	DN60	2 1/2" (DN65)	38954



S3/6243G Straight male connector

Press x BSP male taper thread

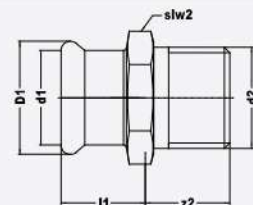

Size	l1	d1	D1	z2	slw2	sks2	DN1	DN2	Code
12mm x R3/8"	17	12	19	9	19	21	DN10	3/8" (DN10)	38105
12mm x R1/2"	17	12	19	11	19	21	DN10	1/2" (DN15)	38106
15mm x R3/8"	20	15	23	7	21	24	DN12	1/2" (DN15)	38107
15mm x R1/2"	20	15	23	8	21	24	DN12	1/2" (DN15)	38114
15mm x R3/4"	20	15	23	10	25	27	DN12	1/2" (DN15)	38115
18mm x R1/2"	20	18	26	9	25	27	DN15	1/2" (DN15)	38108
18mm x R3/4"	20	18	26	10	25	27	DN15	3/4" (DN20)	38109
22mm x R1/2"	21	22	31	9	30	32	DN20	3/4" (DN20)	38110
22mm x R3/4"	21	22	31	10	30	32	DN20	3/4" (DN20)	38116
22mm x R1"	21	22	31	11	32	34	DN20	3/4" (DN20)	38117
28mm x R3/4"	23	28	37	10	36	38	DN25	3/4" (DN20)	38111
28mm x R1"	23	28	37	11	36	38	DN25	1" (DN25)	38118
28mm x R1 1/4"	23	28	37	12	36	42	DN25	1 1/4" (DN32)	38127
35mm x R1"	26	35	44	12	41	44	DN32	1 1/4" (DN32)	38112
35mm x R1 1/4"	26	35	44	15	41	44	DN32	1 1/4" (DN32)	38119
42mm x R1 1/4"	30	42	53	16	51	54	DN40	1 1/4" (DN32)	38113
42mm x R1 1/2"	30	42	53	16	51	53	DN40	1 1/2" (DN40)	38120
54mm x R2"	35	54	65	12	-	66	DN50	2" (DN50)	38121
64mm x R2 1/2"	50	64	80	34	66	76	DN60	2 1/2" (DN65)	38956
66.7mm x R2 1/2"	50	67	83	25	74	82	DN65	2 1/2" (DN65)	38122
76.1mm x R2 1/2"	50	76	94	31	76	88	DN65	2 1/2" (DN65)	38126
76.1mm x R3"	50	76	94	39	77	89	DN65	3" (DN80)	38123
88.9mm x R3"	62	89	108	30	100	105	DN80	3" (DN80)	38125
108mm x R4"	68	108	132	38	107	124	DN100	4" (DN100)	38124



S6/7243 Reducer

Larger end male for insertion into fitting x press

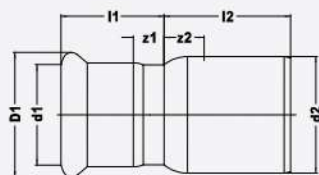

Size	l1	d1	D1	z1	l2	d2	z2	DN1	DN2	Code
15 x 12mm	21	12	19	4	23	15	3	DN10	DN12	38193
18 x 12mm	21	12	19	4	26	18	6	DN10	DN15	38196
18 x 15mm	24	15	23	4	23	18	3	DN12	DN15	38197
22 x 15mm	24	15	23	4	28	22	7	DN12	DN20	38200
22 x 18mm	24	18	26	4	26	22	5	DN15	DN20	38201
28 x 15mm	25	15	23	4	3	28	14	DN12	DN25	38202
28 x 18mm	26	18	26	4	35	28	12	DN15	DN25	38203
28 x 22mm	25	22	31	4	30	28	7	DN20	DN25	38204
35 x 22mm	29	22	31	9	39	35	13	DN20	DN32	38207
35 x 28mm	28	28	37	5	35	35	9	DN25	DN32	38208
42 x 22mm	25	22	31	4	49	42	19	DN20	DN40	38210
42 x 28mm	27	28	37	4	44	42	14	DN25	DN40	38211
42 x 35mm	35	35	44	8	38	42	8	DN32	DN40	38212
54 x 28mm	27	28	37	4	59	54	24	DN25	DN50	38215
54 x 35mm	35	35	44	9	53	54	18	DN32	DN50	38216
54 x 42mm	40	42	53	9	47	54	12	DN40	DN50	38217
66.7 x 28mm	37	28	37	14	72	67	22	DN25	DN65	38218
66.7 x 35mm	40	35	44	14	69	67	19	DN32	DN65	38219
66.7 x 42mm	43	42	53	13	67	67	17	DN40	DN65	38220
66.7 x 54mm	49	54	65	14	63	67	13	DN50	DN65	38221
76.1 x 35mm	39	35	44	13	74	76	24	DN32	DN65	38222
76.1 x 42mm	43	42	53	13	70	76	20	DN40	DN65	38223
76.1 x 54mm	52	54	65	17	64	76	14	DN50	DN65	38224
76.1 x 66.7mm	66	67	83	16	60	76	10	DN65	DN65	38225
108 x 42mm	47	42	53	17	106	108	39	DN40	DN100	38228
108 x 54mm	54	54	65	20	102	108	35	DN50	DN100	38229
108 x 66.7mm	70	67	83	20	96	108	29	DN65	DN100	38230
108 x 76.1mm	70	76	94	20	92	108	25	DN65	DN100	38231
108 x 88.9mm	82	88.9	108	20	84	108	17	DN80	DN100	38232
88.9 x 42mm	46	42	53	16	89	88.9	27	DN40	DN80	38233



S11/6330 Union coupling

Press x press

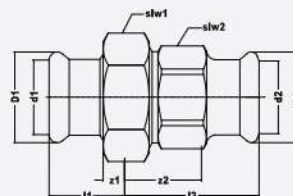

Size	l1	d1	D1	z1	slw1	sks1	l2	d2	D2	z2	slw2	sks2	DN1	DN2	Code
15mm	27	15	23	7	30	34	33	15	23	13	25	27	DN12	DN12	38180
18mm	29	18	26	9	30	34	33	18	26	13	25	27	DN15	DN15	38179
22mm	31	22	31	10	36	41	37	22	31	16	32	34	DN20	DN20	38181
28mm	33	28	37	10	46	49	41	28	37	17	40	42	DN25	DN25	38182
35mm	33	35	44	7	52	56	38	35	44	14	46	46	DN32	DN32	38183
42mm	41	42	53	11	58	61	50	42	53	20	51	54	DN40	DN40	38184
54mm	48	54	65	13	75	79	51	54	65	16	65	70	DN50	DN50	38185

S12/7002A Elbow

Press x press



Size	l1	d1	D1	z1	l2	d2	D2	z2	DN1	DN2	Code
12mm	31	12	19	14	31	12	19	14	DN10	DN10	38279
15mm	38	15	23	17	38	15	23	17	DN12	DN12	38280
18mm	42	18	26	22	42	18	26	22	DN15	DN15	38282
22mm	47	22	31	26	47	22	31	26	DN20	DN20	38290
28mm	56	28	37	34	56	28	37	34	DN25	DN25	38300
35mm	68	35	44	42	68	35	44	42	DN32	DN32	38302
42mm	80	42	53	50	80	42	53	50	DN40	DN40	38304
54mm	100	54	65	65	100	54	65	65	DN50	DN50	38306
66.7mm	132	67	83	87	132	67	83	87	DN65	DN65	38307
76.1mm	142	76	94	92	142	76	94	92	DN65	DN65	38308
88.9mm	170	89	108	106	170	89	108	106	DN80	DN80	38309
108mm	201	108	132	135	201	108	132	135	DN100	DN100	38310

S12R/7002A Reduced Elbow

Press x press

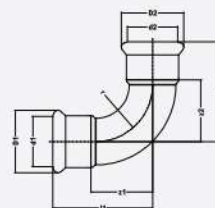

Size	l1	d1	D1	z1	l2	d2	D2	z2	DN1	DN2	Code
22 x 15mm	48	22	31	27	53	15	23	33	DN20	DN15	38311



S12S/7001A Street Elbow

Press x male end for insertion into an XPress fitting

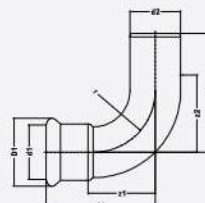

Size	l1	d1	D1	z1	l2	d2	z2	DN1	DN2	Code
12mm	31	12	19	14	45	12	28	DN10	DN10	38317
15mm	36	15	23	16	50	15	30	DN12	DN12	38318
18mm	42	18	26	22	53	18	33	DN15	DN15	38319
22mm	47	22	31	27	58	22	37	DN20	DN20	38320
28mm	58	28	37	34	64	28	41	DN25	DN25	38322
35mm	69	35	44	44	82	35	56	DN32	DN32	38324
42mm	81	42	53	52	101	42	71	DN40	DN40	38325
54mm	100	54	65	66	120	54	85	DN50	DN50	38326
66.7mm	130	67	83	93	175	67	125	DN65	DN65	38327A
76.1mm	143	76	94	93	150	76	100	DN65	DN65	38328
88.9mm	170	89	108	112	178	89	114	DN80	DN80	38329
108mm	197	108	133	130	208	108	144	DN100	DN100	38330A

S13/6092G Male elbow

Press x BSP male taper thread

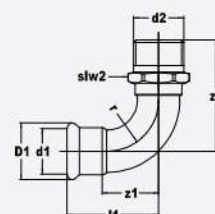

Size	l1	d1	D1	z1	l2	z2	DN1	DN2	Code
12mm x 3/8"	36	12	19	19	25	19	DN10	3/8" (DN10)	38371
12mm x 1/2"	40	12	19	23	26	18	DN10	1/2" (DN15)	38370
15mm x 3/8"	43	15	23	12	24	18	DN12	3/8" (DN10)	38339
15mm x 1/2"	38	15	23	19	34	26	DN12	1/2" (DN15)	38333
18mm x 1/2"	42	18	26	15	37	29	DN15	1/2" (DN15)	38340
18mm x 3/4"	47	18	26	18	31	22	DN15	3/4" (DN20)	38372
22mm x 3/4"	47	22	31	28	43	34	DN20	3/4" (DN20)	38334
28mm x 1"	58	28	37	36	53	43	DN25	1" (DN25)	38335
35mm x 1 1/4"	55	35	44	30	47	35	DN25	1 1/4" (DN32)	38336
42mm x 1 1/2"	62	42	53	32	51	38	DN40	1 1/2" (DN40)	38337
54mm x 2"	70	54	65	35	63	47	DN80	2" (DN50)	38338



S14/6090G Female elbow

Connection: Press x BSP parallel female thread

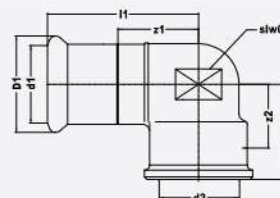

Size	l1	d1	D1	z1	slw0	l2	z2	DN1	DN2	Code
12mm x Rp3/8"	39	12	19	22	15	18	10	DN10	3/8" (DN10)	38346
12mm x Rp1/2"	39	12	19	22	26	20	7	DN10	1/2" (DN15)	38345
15mm x Rp3/8"	43	15	23	23	18	18	11	DN12	3/8" (DN10)	38347
15mm x Rp1/2"	41	15	23	21	18	23	12	DN12	1/2" (DN15)	38351
15mm x Rp3/4"	36	15	23	16	31	29	13	DN12	3/4" (DN20)	38344
18mm x Rp1/2"	41	18	26	21	21	24	14	DN15	1/2" (DN15)	38348
18mm x Rp3/4"	52	18	26	32	21	25	12	DN15	3/4" (DN20)	38349
22mm x Rp1/2"	37	22	31	16	25	32	13	DN20	1/2" (DN15)	38350
22mm x Rp3/4"	45	22	31	24	25	27	11	DN20	3/4" (DN20)	38353
28mm x Rp1"	51	28	37	28	33	33	14	DN25	1" (DN25)	38354
35mm x Rp1 1/4"	55	35	44	29	46	45	21	DN32	1 1/4" (DN32)	38355
42mm x Rp1 1/2"	63	42	53	35	53	52	26	DN40	1 1/2" (DN40)	38356
54mm x Rp2"	74	54	65	42	65	60	33	DN50	2" (DN50)	38357

S15/6472G Backplate elbow

Connection: Press x BSP parallel female thread

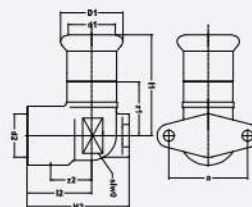

Size	l1	d1	D1	z1	l2	z2	DN1	DN2	Code
12mm x 1/2"	63	12	19	46	25	10	DN10	1/2" (DN15)	38397
15mm x 3/8"	42	15	23	22	38	16	DN12	3/8" (DN10)	38396
15mm x 1/2"	42	15	23	22	20	9	DN12	1/2" (DN15)	38400
18mm x 1/2"	43	18	26	23	24	9	DN15	1/2" (DN15)	38398
22mm x 3/4"	45	22	31	24	27	11	DN20	3/4" (DN20)	38401

S15L/6472L Backplate elbow

Connection: Press x parallel female thread

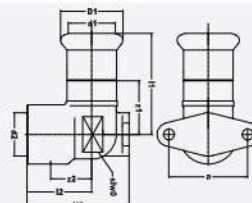

Size	l1	d1	D1	z1	l2	z2	DN1	DN2	Code
15mm x 1/2"	47	15	23	27	48	8	DN12	1/2" (DN15)	38399



S19/7005 90° bend

Both ends male for insertion into an XPress fitting

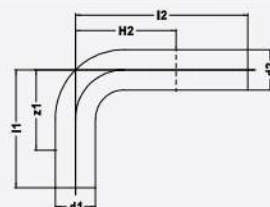

Size	l1	d1	z1	l2	d2	z2	DN1	DN2	Code
15mm	70	15	50	120	15	100	DN12	DN12	38390
18mm	70	18	50	120	18	100	DN15	DN15	38391
22mm	70	22	49	120	22	99	DN20	DN20	38392
28mm	80	28	57	120	28	97	DN25	DN25	38393

S21/7041 Obtuse Elbow

Press x press

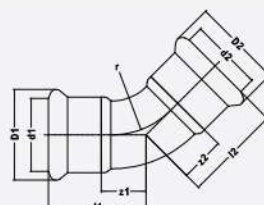

Size	l1	d1	D1	z1	l2	d2	D2	z2	DN1	DN2	Code
12mm	23	12	19	6	23	12	19	6	DN10	DN10	38411
15mm	28	15	23	8	28	15	23	8	DN12	DN12	38410
18mm	29	18	26	9	29	18	26	9	DN15	DN15	38413
22mm	31	22	31	12	31	22	31	12	DN20	DN20	38412
28mm	37	28	37	16	37	28	37	16	DN25	DN25	38414
35mm	44	35	44	18	44	35	44	18	DN32	DN32	38416
42mm	51	42	53	21	51	42	53	21	DN40	DN40	38417
54mm	62	54	65	27	62	54	65	27	DN50	DN50	38418
66.7mm	85	67	83	35	85	67	83	35	DN65	DN65	38419
76.1mm	91	76	94	45	91	76	94	45	DN65	DN65	38420
88.9mm	109	89	108	46	109	89	108	46	DN80	DN80	38422
108mm	125	108	132	59	125	108	132	59	DN100	DN100	38421



S21S/7040

Obtuse street elbow

Press x male end for insertion into an XPress fitting

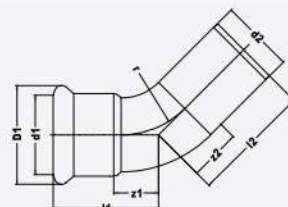

Size	l1	d1	D1	z1	l2	d2	z2	DN1	DN2	Code
12mm	23	12	19	6	32	12	15	DN10	DN10	38402
15mm	28	15	23	8	37	15	17	DN12	DN12	38404
18mm	29	18	26	9	39	18	19	DN15	DN15	38403
22mm	32	22	31	11	44	22	23	DN20	DN20	38405
28mm	37	28	37	14	47	28	24	DN25	DN25	38406
35mm	43	35	44	17	58	35	32	DN32	DN32	38407
42mm	51	42	53	21	71	42	41	DN40	DN40	38408
54mm	62	54	65	27	82	54	47	DN50	DN50	38409
66.7mm	85	67	83	35	88	67	38	DN65	DN65	38430
76.1mm	90	76	94	40	97	76	54	DN65	DN65	38431
88.9mm	109	89	108	47	116	89	54	DN80	DN80	38433
108mm	115	108	133	48	136	108	69	DN100	DN100	38432A

S22/7086

Partial crossover

Press x male end for insertion into an XPress fitting

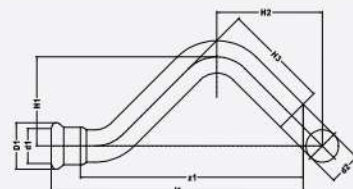

Size	l1	d1	D1	z1	d2	DN1	DN2	Code
15mm	110	15	23	90	15	DN12	DN12	38435
18mm	120	18	26	100	18	DN15	DN15	38437
22mm	134	22	31	113	22	DN20	DN20	38436

S22S/7087

Street crossover

Both ends male for insertion into an XPress fitting

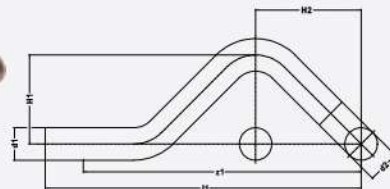

Size	l1	d1	d2	DN1	DN2	Code
15mm	118	15	15	DN12	DN12	38438
18mm	128	18	18	DN15	DN15	38434
22mm	142	22	22	DN20	DN20	38439



S23/7085 Full crossover

Press x press

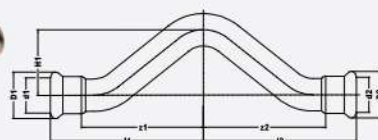

Size	l1	d1	D1	z1	l2	d2	D2	z2	DN1	DN2	Code
15mm	70	15	23	50	70	15	23	50	DN12	DN12	38440
18mm	76	18	26	56	76	18	26	56	DN15	DN15	38442
22mm	85	22	31	64	85	22	31	64	DN20	DN20	38441

S24/7130 Equal tee

Press x press

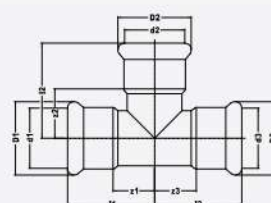
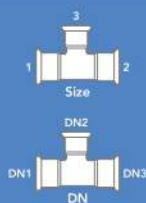

Size	l1	d1	D1	z1	l2	d2	D2	z2	l3	d3	D3	z3	DN1	DN2	DN3	Code
12mm	28	12	19	11	28	12	19	11	28	12	19	11	DN10	DN10	DN10	38472
15mm	32	15	23	12	32	15	23	12	32	15	23	12	DN12	DN12	DN12	38450
18mm	34	18	26	14	34	18	26	14	34	18	26	14	DN15	DN15	DN15	38451
22mm	37	22	31	16	37	22	31	16	37	22	31	16	DN20	DN20	DN20	38460
28mm	42	28	37	19	42	28	37	19	42	28	37	19	DN25	DN25	DN25	38462
35mm	50	35	44	24	50	35	44	24	50	35	44	24	DN32	DN32	DN32	38464
42mm	58	42	53	28	58	42	53	28	58	42	53	28	DN40	DN40	DN40	38466
54mm	69	54	65	34	69	54	65	34	69	54	65	34	DN50	DN50	DN50	38467
66.7mm	95	67	83	45	111	67	83	61	95	67	83	45	DN65	DN65	DN65	38468A
76.1mm	101	76	94	51	119	76	94	69	101	76	94	51	DN65	DN65	DN65	38469A
88.9mm	162	-	-	100	162	-	-	100	162	-	-	100	DN80	DN80	DN80	38470A
108mm	136	108	133	69	154	108	133	87	136	108	133	69	DN100	DN100	DN100	38471A

LBP PRESS FITTINGS FOR JOINTING COPPER TUBE



S25/7130 Tee, reduced branch

Press on all ends

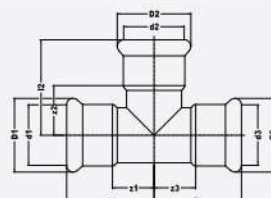
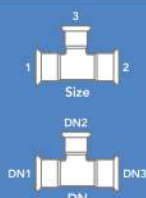

Size	L1	d1	D1	z1	L2	d2	D2	z2	L3	d3	D3	z3	DN1	DN2	DN3	Code
15 x 15 x 12mm	32	15	23	12	32	12	19	15	32	15	23	12	DN12	DN10	DN12	38488
18 x 18 x 12mm	34	18	26	14	35	12	19	15	34	18	26	14	DN15	DN10	DN15	38452
18 x 18 x 15mm	34	18	26	14	35	15	23	15	34	18	26	14	DN15	DN12	DN15	38454
22 x 22 x 12mm	37	22	31	16	34	12	19	17	37	22	31	16	DN20	DN10	DN20	38491
22 x 22 x 15mm	37	22	31	16	38	15	23	18	37	22	31	16	DN20	DN12	DN20	38490
22 x 22 x 18mm	37	22	31	16	38	18	26	18	37	22	31	16	DN20	DN15	DN20	38535
28 x 28 x 12mm	42	28	37	19	37	12	19	20	42	28	37	19	DN25	DN10	DN25	38493
28 x 28 x 15mm	42	28	37	19	41	15	23	21	42	28	37	19	DN25	DN12	DN25	38492
28 x 28 x 18mm	42	28	37	19	41	18	26	21	42	28	37	19	DN25	DN15	DN25	38538
28 x 28 x 22mm	42	28	37	19	41	22	31	20	42	28	37	19	DN25	DN20	DN25	38494
35 x 35 x 15mm	45	35	44	19	44	15	23	24	45	35	44	19	DN32	DN12	DN32	38496
35 x 35 x 22mm	45	35	44	19	45	22	31	24	45	35	44	19	DN32	DN20	DN32	38497
35 x 35 x 28mm	50	35	44	24	44	28	37	21	50	35	44	24	DN32	DN25	DN32	38498
42 x 42 x 15mm	50	42	53	20	48	15	23	28	50	42	53	20	DN40	DN12	DN40	38499
42 x 42 x 22mm	50	42	53	20	48	22	31	27	50	42	53	20	DN40	DN20	DN40	38500
42 x 42 x 28mm	56	42	53	26	49	28	37	26	56	42	53	26	DN40	DN25	DN40	38501
42 x 42 x 35mm	56	42	53	26	50	35	44	24	56	42	53	26	DN40	DN32	DN40	38502
54 x 54 x 22mm	60	54	65	25	54	22	31	33	60	54	65	25	DN50	DN20	DN50	38504
54 x 54 x 28mm	60	54	65	25	55	28	37	32	60	54	65	25	DN50	DN25	DN50	38505
54 x 54 x 35mm	61	54	65	24	55	35	44	29	61	54	65	24	DN50	DN32	DN50	38506
54 x 54 x 42mm	69	54	65	34	64	42	53	34	69	54	65	34	DN50	DN40	DN50	38507
66.7 x 66.7 x 28mm	76	67	83	26	67	28	37	43	76	67	83	26	DN65	DN25	DN65	38550
66.7 x 66.7 x 35mm	80	67	83	29	70	35	44	43	80	67	83	29	DN65	DN32	DN65	38560
66.7 x 66.7 x 42mm	82	67	83	32	76	42	53	41	82	67	83	32	DN65	DN40	DN65	38561
66.7 x 66.7 x 54mm	88	67	83	47	78	54	65	43	88	67	83	47	DN65	DN50	DN65	38562
76.1 x 76.1 x 22mm	73	76	94	22	73	22	31	50	73	76	94	22	DN65	DN20	DN65	38563
76.1 x 76.1 x 28mm	77	76	94	26	73	28	37	50	77	76	94	26	DN65	DN25	DN65	38564
76.1 x 76.1 x 35mm	80	76	94	30	78	35	44	53	80	76	94	30	DN65	DN32	DN65	38553
76.1 x 76.1 x 42mm	103	76	94	55	106	42	53	70	103	76	94	55	DN65	DN40	DN65	38551
76.1 x 76.1 x 54mm	93	76	94	41	85	54	65	50	93	76	94	60	DN65	DN50	DN65	38552
88.9 x 88.9 x 54mm	136	88.9	108	77	119	54	65	77	136	88.9	108	77	DN80	DN50	DN80	38554A
108 x 108 x 54mm	109	108	133	125	125	54	65	91	109	108	133	125	DN100	DN54	DN100	38555A
88.9 x 88.9 x 76mm	151	88.9	108	91	146	76.1	94	96	151	88.9	108	91	DN80	DN65	DN80	38556A
108 x 108 x 66.7mm	117	108	133	46	141	67	83	96	117	108	133	50	DN100	DN65	DN100	38565A
108 x 108 x 76.1mm	120	108	133	52	139	76	94	52	120	108	133	53	DN100	DN80	DN100	38557A
108 x 108 x 88.9mm	126	108	133	59	151	89	108	89	126	108	133	59	DN100	DN80	DN100	38558A



S32/6131G

Female branch tee with multi ports

Press x press

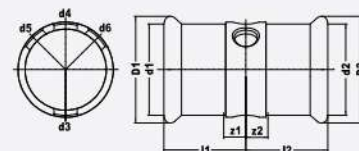

Size	l1	d1	D1	es1	z1	l2	d2	D2	es2	z2	DN1	DN2	DN3	DN4	DN5	DN6	Code
66.7mm x 1/2"	65	67	83	65	15	65	67	83	51	15	DN65	DN65	1/2" (DN15)	1/2" (DN15)	N/A	N/A	38189
76.1mm x 1/2"	65	76	94	65	14	65	76	94	51	14	DN65	DN65	1/2" (DN15)	1/2" (DN15)	N/A	N/A	38188
88.9mm x 3/4"	80	89	108	80	18	80	89	108	62	18	DN80	DN80	3/4" (DN20)	3/4" (DN20)	3/4" (DN20)	N/A	38192
108mm x 3/4"	85	108	132	85	18	85	108	132	68	18	DN100	DN100	3/4" (DN20)	3/4" (DN20)	3/4" (DN20)	3/4" (DN20)	38206

S60

Stop end

Male end for insertion into an XPress fitting

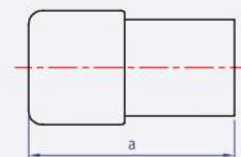

Size	l1	d1	es1	z1	DN1	Code
35mm	96	35	26	70	DN32	38686
42mm	108	42	32	76	DN40	38688
54mm	125	54	37	89	DN50	38690

S61/7301

Stop end

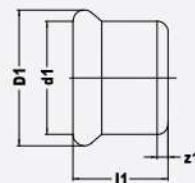

Size	l1	d1	D1	z1	DN1	Code
12mm	17	12	19	2	DN10	38702
15mm	20	15	23	2	DN12	38695
18mm	20	18	26	2	DN15	38696
22mm	21	22	31	2	DN20	38697
28mm	23	28	37	2	DN25	38698
35mm	26	35	44	2	DN32	38699
42mm	30	42	53	2	DN40	38700
54mm	35	54	65	2	DN50	38701
66.7mm	50	67	83	2	DN65	38691
76.1mm	50	76	94	2	DN65	38692
108mm	67	108	132	2	DN100	38694